



Task Title: Interpret Blueprints

OALCF Cover Sheet – Practitioner Copy

Learner Name: _____

Date Started: _____

Date Completed: _____

Successful Completion: Yes ☐ No ☐

Goal Path:

Employment	<input checked="" type="checkbox"/>	Apprenticeship	<input checked="" type="checkbox"/>
Secondary School	<input type="checkbox"/>	Post Secondary	<input type="checkbox"/>
		Independence	<input type="checkbox"/>

Task Description: The learner will read a blueprint and excerpts from the Ontario Building Code to answer questions and inform a customer about modifications to their home.

Main Competency/Task Group/Level Indicator:

- Find and Use Information/Interpret documents/A2.2
- Communicate Ideas and Information/Write continuous text/B2.2

Materials Required:

- Pen/pencil and paper and/or digital device

Task Title: InterpretBlueprints_EA_A2.2_B2.2

Learner Information

Carpenters interpret blueprints and other scale drawings to determine placement of building materials. They also consult the Building Code to determine if modifications are legal.

Scan the **A1.01 First Floor Plan** and the **2024 Ontario Building Code Compendium 9.7.2.2 and 9.7.2.3** excerpts.

Task Title: InterpretBlueprints_EA_A2.2_B2.2

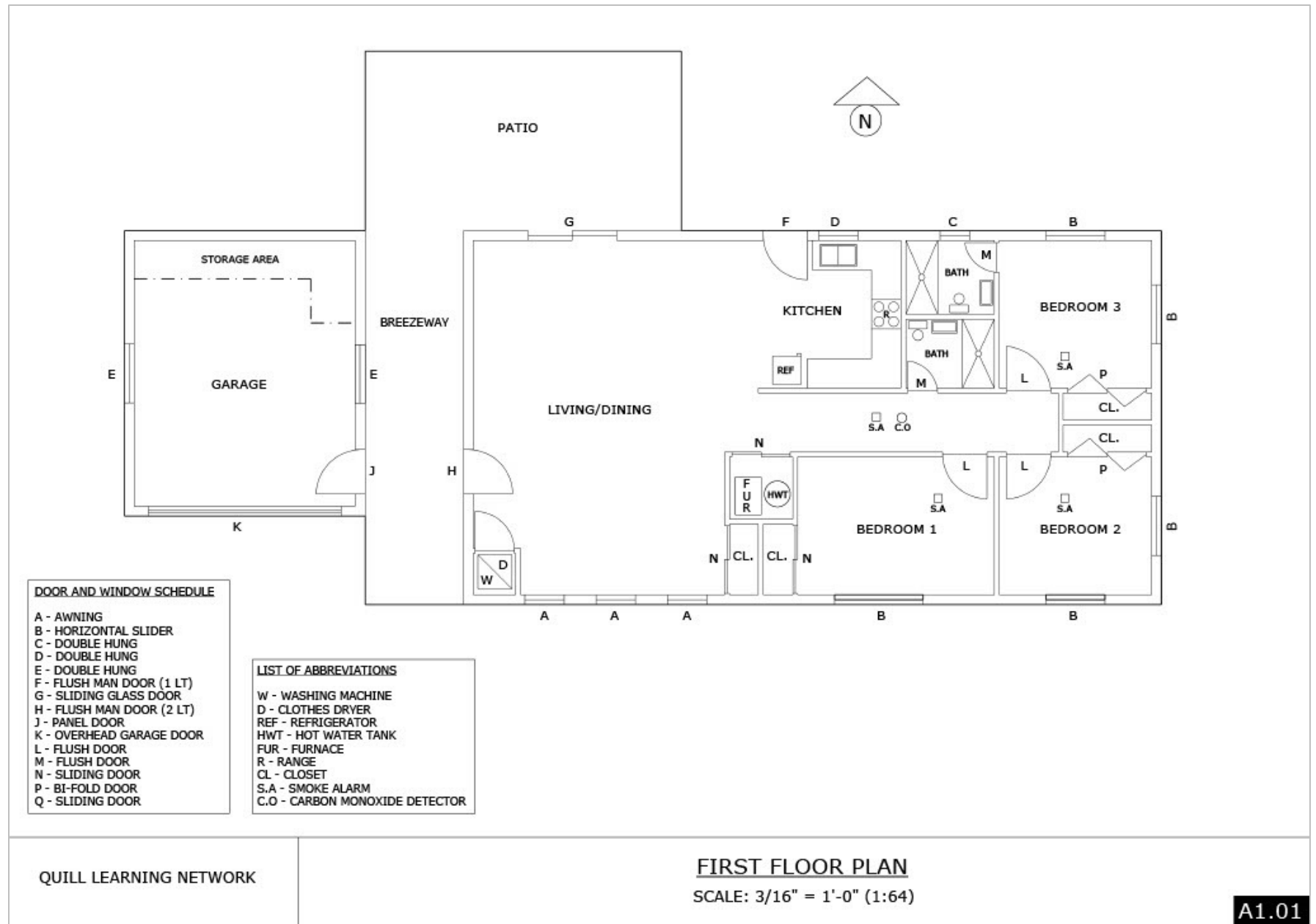

- (4) Windows and doors installed to provide the required *means of egress* from bedrooms shall conform to Subsection 9.9.10.
- (5) The location and protection of windows, doors and skylights in order to control the spread of fire shall conform to Subsection 9.10.12.
- (6) Doors between *dwelling units* and attached garages shall conform to Article 9.10.13.15.
- (7) The surface *flame-spread rating* for doors and skylights shall conform to Article 9.10.17.1.
- (8) Windows and doors installed to provide the required access to a *building* for firefighting purposes shall conform to Subsection 9.10.20.
- (9) Windows and skylights installed to provide required non-heating season ventilation shall conform to Article 9.32.2.2.

9.7.2.3. Minimum Window Areas

- (1) Except as required in Article 9.9.10.1. and Sentence (3), the minimum window glass areas for rooms in *buildings of residential occupancy* or rooms that are used for sleeping shall conform to Table 9.7.2.3.
- (2) The unobstructed glass area of a door or skylight is considered equivalent to that of a window.
- (3) Work areas in *live/work units* shall conform to Clause 3.7.2.1.(2)(a).
- e2 (4) Where rooms with different requirements for window glass area are combined as described in Sentence 9.5.1.2.(1), the more restrictive requirement shall govern.

Table 9.7.2.3.
Glass Areas for Rooms of Residential Occupancy
Forming Part of Sentence 9.7.2.3.(1)

Location	Minimum Unobstructed Glass Area With No Electric Lighting	Minimum Unobstructed Glass Area With Electric Lighting
Laundry, basement recreation room, unfinished basement	4% of area served	Windows not required
Water-closet room	0.37 m ²	Windows not required
Kitchen, kitchen space, kitchen alcove	10% of area served	Windows not required
Living rooms and dining rooms	10% of area served	10% of area served
Bedrooms and other finished rooms not mentioned above	5% of area served ⁽¹⁾	5% of area served ⁽¹⁾

Notes to Table 9.7.2.3.:

(1) See Subsection 9.9.10.

Work Sheet

Task 1: What type of door separates the Living/Dining Room from the Furnace Room?

Answer:

Task 2: On which side of the Living Room are the awning type of windows found?

Answer:

Task 3: Which bedrooms have bi-fold doors?

Answer:

Task 4: What is the minimum unobstructed glass area required for a laundry room with no electric lighting?

Answer:

Task 5: Bedroom 1 is 7.5' x 9'. The owner wants to have the closet run the whole length of the south wall. Using the excerpt from the Building Code, write a note to the customer explaining why that is not possible.

Answer:

Answers

Task 1: What type of door separates the Living/Dining Room from the Furnace Room?

Answers: Sliding Door (N)

Task 2: On which side of the Living Room are the awning type of windows found?

Answer: South

Task 3: Which bedrooms have bi-fold doors?

Answer: Bedrooms 2 and 3

Task 4: What is the minimum unobstructed glass area required for a laundry room with no electric lighting?

Answer: 4% of the area served

Task 5: Bedroom 1 is 7.5' x 9'. The owner wants to have the closet run the whole length of the south wall. Using the excerpt from the Building Code, write a brief note to the customer explaining why that is not possible. Include a greeting and your name.

Answer: Something similar to:

Hi (Insert fictitious name). According to the 2024 Ontario Building Code 9.7.2.3.(1) and Table 9.7.2.3. a bedroom requires a minimum of 5% natural light to the area served. By constructing a closet along the noted (south) wall, the natural light will become restricted/blocked and therefore would not meet the minimum building code requirements.

(Insert their name or another fictitious name)

Performance Descriptors

Levels	Performance Descriptors	Needs Work	Completes task with support from practitioner	Completes task independently
A2.2	Performs limited searches using one or two search criteria			
	Extracts information from tables and forms			
	Uses layout to locate information			
	Makes connections between parts of documents			
	Makes low-level inferences			
	Begins to identify sources and evaluate information			
B2.2	Writes texts to explain or describe			
	Conveys intended meaning on familiar topics for a limited range of purposes and audiences			
	Connects ideas using paragraph structure			
	Uses a limited range of vocabulary and punctuation appropriate to the task			
	Begins to select words and tone appropriate to the task			
	Begins to organize writing to communicate effectively			

This task: Was successfully completed ☐ Needs to be tried again ☐

Task Title: InterpretBlueprints_EA_A2.2_B2.2

Learner Comments:

Instructor (print):

Learner (print):